

THE CHATEAU CELLAR/BASEMENT

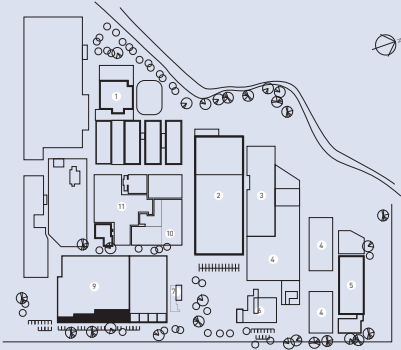

- Foyer and common area refurbishment is conceptual and can be designed with tenant requirements in mind
- Areas: South 360m², North 242m² (Subject to survey)
- Combinations of floor areas possible
- Refurbished office accommodation
- New carpet, ceilings, base building lighting
- Open planned or partitioned to requirements
- Reverse cycle A/c
- Each area has kitchenette
- Lift access

While Tarac Properties Pty Ltd and Beckwith Park strives to ensure that the information contained in this brochure is accurate and reliable, Tarac Properties Pty Ltd and Beckwith Park makes no warranties or representations as to the accuracy, correctness, reliability or otherwise with respect to such information, and assumes no liability or responsibility for any omissions or errors in the content of this brochure. All areas are approximate.

